



Manifolds

Our **Competition Holley** manifolds have been designed for serious circle track performance. These manifolds will put you a step ahead of your competition, and our customers have the wins to prove it.

Features Include:

- Large raised plenum for increased air flow and fuel atomization
- Carburetor is turned sideways to provide efficient air and fuel distribution
- Runners distribute fuel and air evenly to each cylinder
- Additional carb spacers available (see page 16)

Note: Holley Manifolds are not recommended for Street, Off-Road, or Buggy Applications



Part# E2724-5K

2.3 Holley Manifold for a cast iron head (D-Port or Oval Port)



**Part# E2727K (SVO)
Part# E2727A (ARCA)**

2.3 Holley Manifold for an aluminum head



Part# E1332

2.0 Holley Manifold for a cast iron head

Weber



Weber Dual Side Draft

Part# E2725 for Esslinger Aluminum Head (use E3365 Linkage Kit)

For those who use Weber carburetors, we offer two manifolds that utilize 45mm, 48mm, and 55mm carbs.

Recommended Applications:

- CORR/SCORE Series

(2.3 Weber manifolds require a crankfire ignition)



Weber Dual Down Draft

Part# E2329 for Esslinger Alum. Head

Part# E2331 for Cast Iron (D-port or Oval)

Weber Linkage Kits:

Part# E3364 - For 44mm Carbs

Part# E3364-5 - For 48mm Carbs

Part# E2726

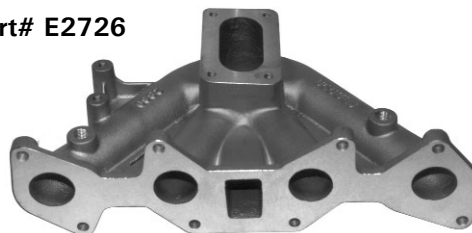

83'-85' Ranger 2.3 Manifold

- Machined for Weber 5200 Series
- Holley 350/500 will bolt on with E3339 adapter (page 16)
- Will fit only round port heads

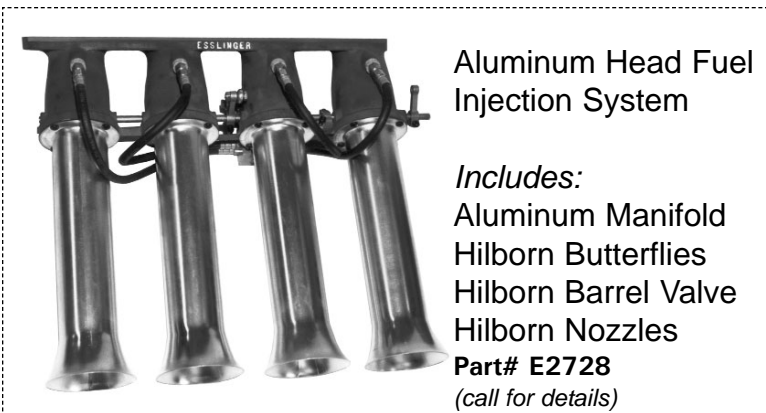

Aluminum Head Fuel Injection System

Includes:

- Aluminum Manifold
- Hilborn Butterflies
- Hilborn Barrel Valve
- Hilborn Nozzles

Part# E2728

(call for details)

Injection Stacks Not Included